

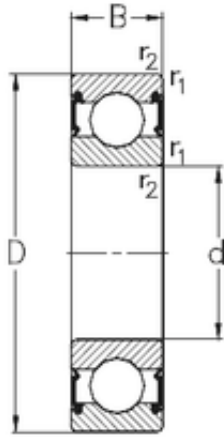

REXROTH BEARINGS DEVELOPMENT LTD



55 mm x 90 mm x 18 mm NKE 6011-RS2 deep groove ball bearings

Bearing No. 6011-RS2

Size	55x90x18 mm
Bore Diameter	55 mm
Outer Diameter	90 mm
Width	18 mm
d	55 mm
D	90 mm
B	18 mm
C	18 mm
r1 min.	1,1 mm
r2 min.	1,1 mm
Weight	0,311 Kg
Basic dynamic load rating (C)	28,2 kN
Basic static load rating (C0)	21,3 kN

6011-RS2 Bearing 2D drawings and 3D CAD models