

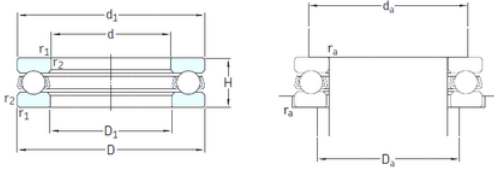

REXROTH BEARINGS DEVELOPMENT LTD



SKF 51208 thrust ball bearings

Bearing No. 51208

Size	40x68x19 mm
Bore Diameter	40 mm
Outer Diameter	68 mm
Width	19 mm
d	40 mm
D	68 mm
H	19 mm
d1	68 mm
r1 min.	1 mm
r2 min.	1 mm
D1	42 mm
da min.	57 mm
Da max.	51 mm
ra max.	1 mm
Weight	0,28 Kg
Basic dynamic load rating (C)	44,2 kN
Basic static load rating (C0)	96,5 kN
Fatigue load limit (Pu)	3,6
Reference speed	3800 r/min
Limiting speed	5300 r/min
Category	Thrust Ball Bearing
Inventory	0.0
Manufacturer Name	SKF
Minimum Buy Quantity	N/A
Weight / Kilogram	0.28
EAN	7316577057983

51208 Bearing 2D drawings and 3D CAD models



REXROTH BEARINGS DEVELOPMENT LTD

Product Group	B00308
Rolling Element	Ball Bearing
Thrust Bearing	Yes
Single or Double Direction	Single Direction
Banded	No
Cage Material	Steel
Precision Class	ABEC 1 ISO P0
Component Description	Roller Assembly Plus Raceways
Other Features	Single Row
Long Description	40MM Bore 1; 42MM Bore 2; 68MM Outside Diameter; 19MM Height; Ball Bearing; Single Direction; Not Banded; Steel Cage; ABEC 1 ISO P0 Precision
Inch - Metric	Metric
Category	Thrust Ball Bearings
UNSPSC	31171507
Harmonized Tariff Code	8482.10.50.08
Noun	Bearing
Keyword String	Ball Thrust
Manufacturer URL	http://www.skf.com
Manufacturer Item Number	51208
Weight / LBS	0.616
Bore 2	1.654 Inch 42 Millimeter
Overall Height with Aligning Washer	0 Inch 0 Millimeter
Bore 1	1.575 Inch 40 Millimeter
Height	0.748 Inch 19 Millimeter
Outside Diameter	2.677 Inch 68 Millimeter
bore diameter:	40 mm
static load capacity:	96.5 kN
outside diameter:	68 mm



REXROTH BEARINGS DEVELOPMENT LTD

dynamic load capacity:	44.2 kN
overall width:	19 mm
maximum rpm:	5300 RPM
thrust bearing type:	Single-Direction
cage material:	Steel
outside diameter design:	Straight
fillet radius:	1 mm
separable or banded:	Separable
series:	512
precision rating:	ABEC 1 (ISO Class Normal)
d_1	68 mm
D_1	42 mm
$r_{1,2}$ min.	1 mm
d_a min.	57 mm
D_a max.	51 mm
r_a max.	1 mm
Basic dynamic load rating C	44.2 kN
Basic static load rating C_0	96.5 kN
Fatigue load limit P_u	3.6 kN
Minimum load factor A	0.058
Mass bearing (including seat washer where applicable)	0.28 kg